



LEGEND

- BITUMINOUS ROAD
- GRAVEL ROAD
- COUNTY STATE AID HIGHWAY
- E.V. EMERGENT VEGETATION
- O.W. OPEN WATER
- CL. CLEARING
- GRAVEL PIT
- DAM
- INTERMITTENT STREAM
- MARSH AREA
- WOODED OR BRUSH SWAMP

EAST FOX (FOX) LAKE 18-298
 PLANIMETERED AREA = 239 ACRES.
 LITTORAL AREA = 101 ACRES.
 LENGTH OF SHORELINE = 4.4 MILES.
 B.M.#1 = WATER GAUGE ON EAST WING OF CONCRETE STOP-LOG DAM AT OUTLET ON SOUTHEAST CORNER OF LAKE.
 W.S. ELEV. = READING ON WATER GAUGE OF 2.12'
 B.M.#2 = SPIKE IN POWER POLE 30' FROM WATER'S EDGE & ON WEST SIDE OF GRAVEL ROAD AT EASTMOST CORNER OF LAKE.
 W.S. ELEV. = 3.0' BELOW B.M.#2.
 FIELDWORK: E.V.H., 6-21-68.

WEST (EAST) FOX LAKE 18-297
 PLANIMETERED AREA = 472 ACRES.
 LITTORAL AREA = 138 ACRES.
 LENGTH OF SHORELINE = 5.3 MILES.
 ISLAND SHORELINE = 0.1 MILE.
 B.M. = TOP OF IRON PIPE ON N-S SECTION LINE, M.C. ON NORTH SHORE OF EAST ARM.
 W.S. ELEV. = 1.7' BELOW B.M. (2-28-39)
 FIELDWORK: M. MORSE, MAR. 1939.
 OUTLINE DRAWN FROM 1955 AERIAL PHOTOS, CWC-1-68,70.
 NOTE: WEST FOX CONTOURS TAKEN FROM 1939 C.C.C. MAP.

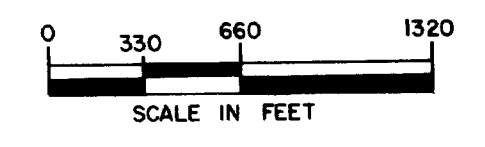

© COPYRIGHT 1993
STATE OF MINNESOTA
DEPARTMENT OF NATURAL RESOURCES
DIVISION OF FISH AND WILDLIFE

STATE OF MINNESOTA
 Department of Administration
 Minnesota's Bookstore
 Part of the Department of Administration
 Print Communications Division
 To order reproduced copies of
 Contour Lake Maps call:
 612/297-3000 or our
 Nationwide toll-free number
 1-800-657-3757

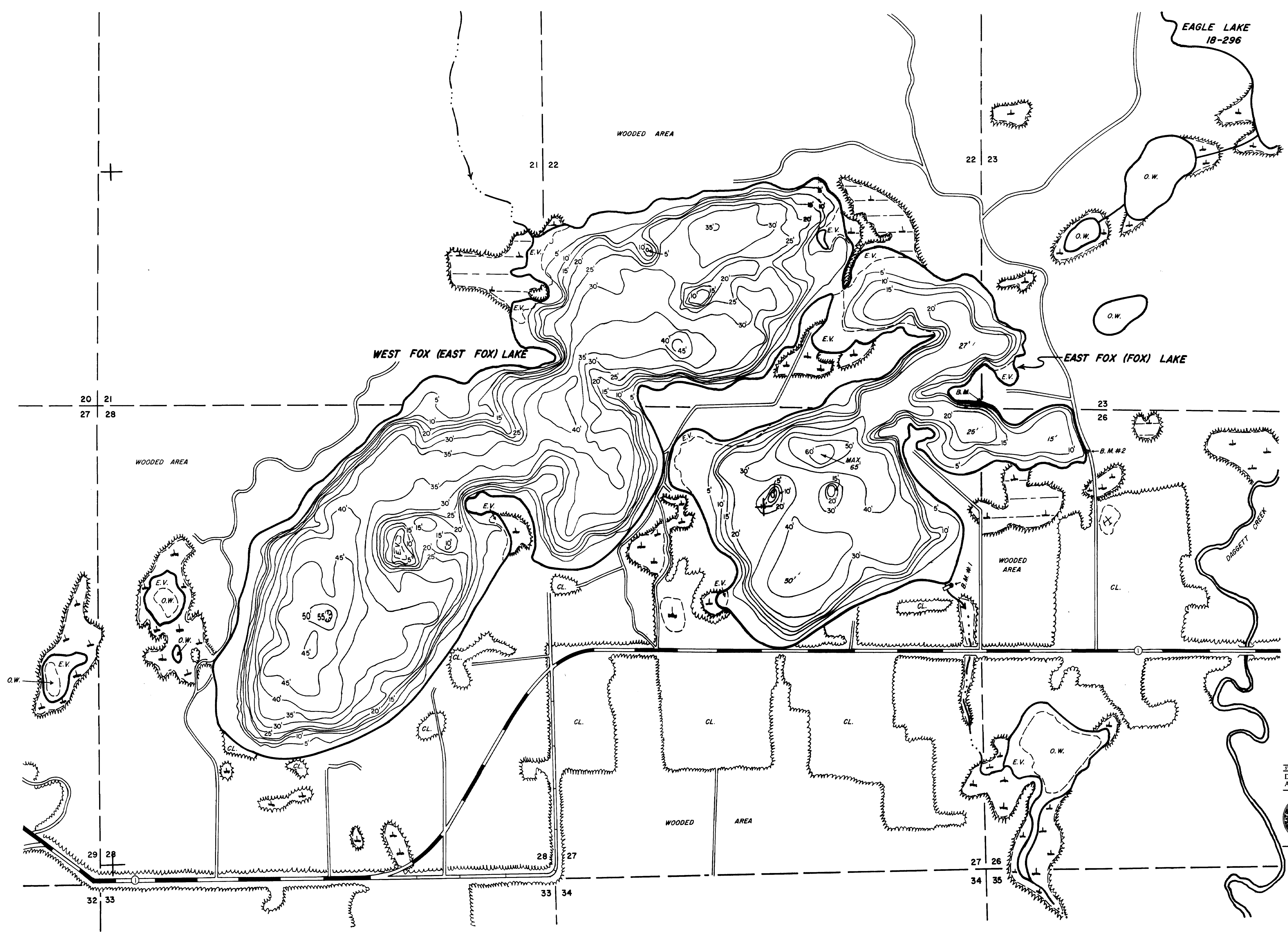

STATE OF MINNESOTA DEPARTMENT OF CONSERVATION		
DIVISION OF GAME AND FISH SECTION OF TECHNICAL SERVICES		
EAST FOX (FOX) AND WEST (EAST) FOX LAKES CROW WING COUNTY		
T. 138 N.	R. 27 N.	S. 21-23, 26-28.
FIELDWORK: M.M. & E.V.H.	DRAWN BY: R.J.M.	PROJ. IDENT. NO.
DATE: 2-28-39 & 6-21-68	DATE: 12-23-68	FW-1R-13

B-0378